

TSAP NEWSLETTER

JANUARY 2022



Lagdu Singh Charitable Trust's (Regd.)

THAKUR SCHOOL OF ARCHITECTURE & PLANNING

(Approved by COA, AICTE, DTE, Govt. of Maharashtra & Affiliated to University of Mumbai)

• Recognized under Section 2f of UGC Act, 1956 • ISO 9001 : 2015 Certified

WHAT'S NEW ?

INSTITUTE ACHIEVEMENT
FACULTY ACHIEVEMENT
EVENTS
STUDENT WORK
STUDENTS' TESTIMONIALS

EDITORIAL TEAM

STUDENT TEAM

Third Year B.Arch.

- Sakshi Chapekar
- Shubham Dhabolkar

FACULTY TEAM

- Gunjan Bagri
- Nimish Bari

STAFF TEAM

- Naresh Pawar

INSTITUTE ACHIEVEMENT



A two day intensive workshop conducted by IIT-K and makeintern.com. The workshop was conducted under the topic of Project management, where the students experienced a hands on work order on software/s and theoretical portion of project management.



A two day intensive workshop conducted by IIT-K and makeintern.com. The workshop was conducted under the topic of Project management, where the students experienced a hands on work order on software/s and theoretical portion of project management.

The session ended with a practical test which led to the following students being selected for a next round of activity at national level:

1. Shubham Dabholkar
2. Jash Shah
3. Anushka Menon
4. Prachi Agarwal
5. Sanjana Malode

TSAP NEWSLETTER

JANUARY 2022



Lagdu Singh Charitable Trust's (Regd.)

THAKUR SCHOOL OF ARCHITECTURE & PLANNING

(Approved by COA, AICTE, DTE, Govt. of Maharashtra & Affiliated to University of Mumbai)

• Recognized under Section 2f of UGC Act, 1956 • ISO 9001 : 2015 Certified



We at TSAP believe to develop a strong connect of students with industry people so institute actively participated in series of webinars organised by Locator Series on a digital platform under the title of "How to Festival 3.0" which enables the student to get insight knowledge on topics directly by industry experts.

\$#*!®

Learn meanings of new four letter words in the all new edition of

HOW TO FESTIVAL 3.0
Discovering Products Through Online Classroom

We hope to see you at the inaugural session
Time : 12.00 noon (60 mins)
Date : Saturday 22nd Jan 2022
Place : Online @LOCATOR Classroom

Brought to you by
LOCATOR
Since 1999
Architect & Designer's Knowledge Platform

© We definitely hope four letter words like LEED, WELL, IGBC all become part of your professional vocabulary!

"Give a man a fish, and you feed him for a day.
Teach a man to fish, and you feed him for a lifetime."

See this come alive when the experts from **GENERAL** reveal all about **VRF Airconditioning systems**. (The systems are so flexible and versatile, that it helps in making interiors look chic!)

So, would you like a one-time learning, to work for you for a lifetime?
Log on to this How To Festival 3.0 webinar.

Date : Saturday, 5th February 2022
Time : 12 noon sharp (60 mins)
Where : The LOCATOR Online Classroom

HOW TO FESTIVAL 3.0
Discovering Products Through Online Classroom

Brought to you by **LOCATOR** Since 1999 Architect & Designer's Knowledge Platform
Presented by **LIC** Since 1956 Life Insurance Corporation of India
Brand partner **GENERAL**

Ask and get rewarded!

Q & A

Keerthi Valsan
Urban Metropolis College of Architecture

Ritesh Chaudhari
Sir J.J. College of Architecture

HERE ARE THE WINNERS OF EPISODE # 3

Rishu Jaiswal
Thakur School of Architecture and Planning

Adiba Saleem
Thakur School of Architecture and Planning

HOW TO FESTIVAL 3.0
Discovering Products Through Online Classroom

The How To Festival 3.0 got off to a grand start, with great learning and many prize winners. You can benefit too! Tune into the event every Saturday at 12 noon on the LOCATOR online classroom.

Brought to you by **LOCATOR** Since 1999 Architect & Designer's Knowledge Platform
Presented by **LIC** Since 1956 Life Insurance Corporation of India
Brand partner **GENERAL**

Locator
Admin • 3h •

Shri Rajeshwari, Parul Uday, Sahil Sabharanjak, and Tabassum
CONGRATULATIONS!... See More

Congratulations Quiz Winners!

HOW TO FESTIVAL 3.0
Discovering Products Through Online Classroom

Shri Rajeshwari
Thakur School of Architecture & Planning, Mumbai

Parul Uday
B.Tech. student of Technology (BIT)

Sahil Sabharanjak
Thakur School of Architecture and Planning

Tabassum
Jawahar Education Society's Faculty of Architecture & Planning

EPISODE #3

The How To Festival 3.0 got off to a grand start, with great learning and many prize winners. You can benefit too! Tune into the event every Saturday at 12 noon on the LOCATOR online classroom.

Brought to you by **LOCATOR** Since 1999 Architect & Designer's Knowledge Platform
Presented by **LIC** Since 1956 Life Insurance Corporation of India
Brand partner **GENERAL**

FACULTY ACHIEVEMENT

Sketch by our faculty Ar. Harita Patil.

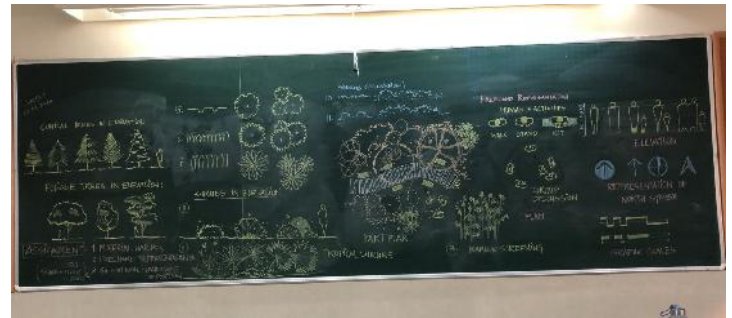
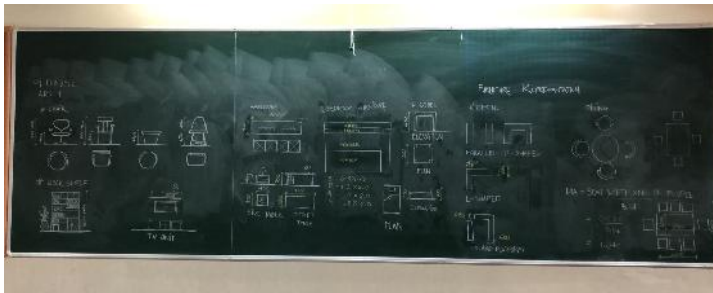
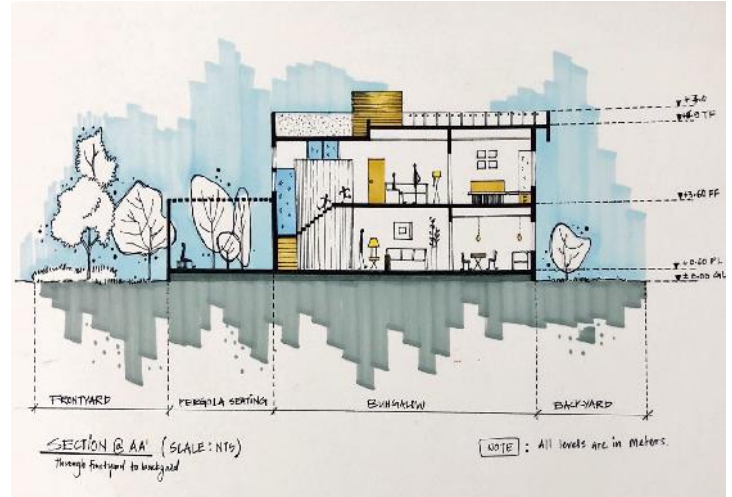

Our faculty Ar. Anubhav Malhotra coordinated for a 2 day workshop with IIT - Kharagpur for a zonal centre program on Project Management.

Our faculty Ar. Tanvi Sawant coordinated for a 2 day workshop with IIT - Kharagpur for a zonal centre program on Project Management.



TSAP NEWSLETTER

JANUARY 2022



Lagdu Singh Charitable Trust's (Regd.)

THAKUR SCHOOL OF ARCHITECTURE & PLANNING

(Approved by COA, AICTE, DTE, Govt. of Maharashtra & Affiliated to University of Mumbai)

• Recognized under Section 2f of UGC Act, 1956 • ISO 9001 : 2015 Certified

Ar. Arimita Roy and Ar. Atul Phoujdar presented their research paper in the 9th Annual International Conference on Sustainable Development, 2021 on topic Pragmatic outlook to improve conventional modus operandi in construction site management: A step towards sustainable development goals in construction.

The International Conference on Sustainable Development (ICSD) provides a forum for academia, government, civil society, UN agencies, and the private sector to come together to share practical solutions to achieve the Sustainable Development Goals (SDGs).

The Conference theme was: "Creating a unified foundation for the Sustainable Development: research, practice and education".



EVENTS - DAY CELEBRATIONS

Celebrating the Spirit of MAKAR SANKRANTI





**Celebrating the Spirit of
MAKAR SANKRANTI**



Friday, 14 January 2022

+91 9321656571

Email : tsap@thakureducation.org | Website : www.tsapmumbai.in



BEST PRACTICES

Students were introduced to electives where they can choose their area of interest and gain expertise under the guidance of a mentor.



Overview
Have you ever pondered, what happens after you design the structure? Have you ever thought about the end product coming shape in to reality? What's the process? How is it resolved? Who all are involved? What's your role?

This Elective will answer all such questions. It will emphasize the process of detailing of such design elements. Will develop a kind of X-ray vision of visualizing the same detail, through the eye of a contractor/consultant. In the process, you will also learn basic management terms like S/Ws, Planning & scheduling, etc.

Learning Outcome
You shall know the process of evolving, resolving & eliminating errors while designing, along with developing a competency in the construction industry.

Expected Outcomes:

Prerequisites
Drawings of Sem - I Architectural Design. (Portfolio)

About Mentor
Ar. Rajesh C. Parmar, Architect & Educator, expertise in Technical Architectural Education, believes in comprehensive approach while Designing & Execution, in conjunction with Creativity & Technical Knowledge, respectively.

Soft Skills

Hard Skills

Allied Skills

Construction, Planning & Management of Details in a Design Project

Conducted By **Ar. Rajesh C. Parmar**
M. Arch. (Project Management)

Expected Outcomes



Overview
"Origami is all about exploring your creative side and enjoying life." In this Elective students would learn to create quick 3D paper models as a conceptualization tool required as a skill for an architect. It would begin with the simple cut, fold & show techniques and progresses to gradually more complex compositions in 3D. Students will also decode the hidden geometries & forming systems to further articulate the composition into actual buildings, furniture pieces & art forms as a part of Applied Origami.

Learning Outcome
You will learn to decode complex geometries using simple paper fold techniques of Origami.

Prerequisites
Curiosity, Zeal, Enthusiasm & Sincerity towards work. Students should also have lot of Patience to learn the skill of Origami.

About Mentor
Ar. Sujit Vasant Jadhav is a humble & creative professional with 24 years of experience in 2d, Architecture & Landscape profession. He believes in "learning by doing approach" through hands-on explorations. This skill to infuse design through various creative mediums in his practice makes him an apt choice to conduct this Elective.

Soft Skills

Hard Skills

Allied Skills

UNFOLDING ARCHITECTURE THROUGH ORIGAMI

Conducted By **Ar. Sujit Vasant Jadhav**
M. Arch. (Landscape Architecture)

Expected Outcomes



Overview
Do you want to know how to create a joyful environment around the building and give the occupants a healthy breath, good appearance and natural beauty. This elective will introduce you to such concepts of landscape design that will enhance your Architecture layouts.

Learning Outcome
You will learn landscape graphics & design of small scale landscape interventions.

Prerequisites
Motivation & keen interest in design and drawing

About Mentor
Ar. Melissa Pereira holds a decade long experience in Architecture, Interior and landscape design practice. She is teaching landscape design for past 7 years and has helped many students to develop their conceptual thinking and design.

Soft Skills

Hard Skills

Allied Skills

LANDSCAPE FUNDAMENTALS

Conducted By : **AR. MELLISSA PEREIRA**
MARCH (SUSTAINABLE ARCH) CEPT UNIVERSITY

Expected Outcomes

Topics of the electives are made in a such a way that student will gain benefit in the curriculum as well as professionally



Overview
Have you wondered how your portfolio could create a better impression? Have you attempted to create sketches as an extension of the ideas in mind and not being satisfied with the drawing? Then this is the elective that sets it straight. Here is a chance to enhance your conceptual idea sketches into masterpieces that can be part of final sheets or any competitive entry. This elective will train you to take such unfinished Interior or Exterior sketches and enhance them using Basic Photoshop skills to create presentable, dramatic outcomes that add new factor to the portfolio.

Learning Outcome
You will have Enhanced Digital Presentation Skills of schematic ideas for Competitions and Final Portfolios.

Prerequisites
Irrespective to sketching abilities develop software skills.

About Mentor
Ar. Anshul D Sinha holds an extensive experience of 18 years in Architectural and Interior Sketching in various mediums. He believes in Designing through 3D sketches and his constant use of digitally enhanced design sketches in his practice makes him apt to conduct this topic.

Soft Skills

Hard Skills

Allied Skills

PORTFOLIO ESSENTIALS

Conducted By **Ar. Anshul D Sinha**
M. Arch. (General)

Expected Outcomes



Overview
With the availability of innovative architecture design technology, is there still a place for physical model making in architecture? "Yes, I believe it's more important than ever" - Ar. Stanton Williams

This Elective is about using the architectural model as a tool for design discovery. When used as an integral part of the design process, study models are capable of generating information in time and offer one of the strongest exploration methods available.

Learning Outcome
You will learn different Characters of designing. Making physical model will help to explore the possibilities of having different solutions.

Prerequisites
Creative inclination & imaginative appetite.

About Mentor
Ar. Harita is a passionate professional with 7+ years of experience in Architectural & Landscape field. She believes in character and story driven designing and will conduct this elective based on her professional experience.

Soft Skills

Hard Skills

Allied Skills

Designing with Models

Conducted By **Ar. Harita Patil**
M. Arch. (P&L)

Expected Outcomes

Introduction to the electives



STUDENTS WORK

CULTURAL TOURISM CENTER AT PUSHKAR

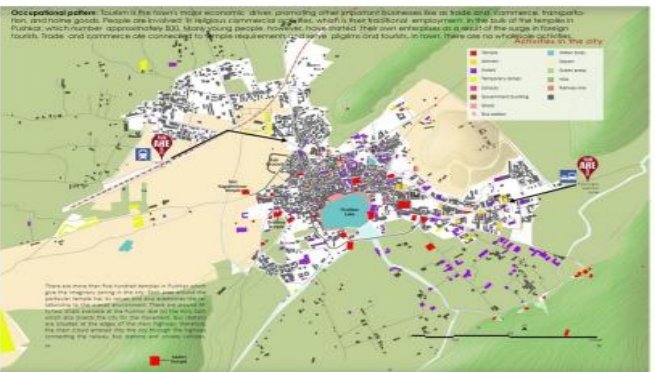
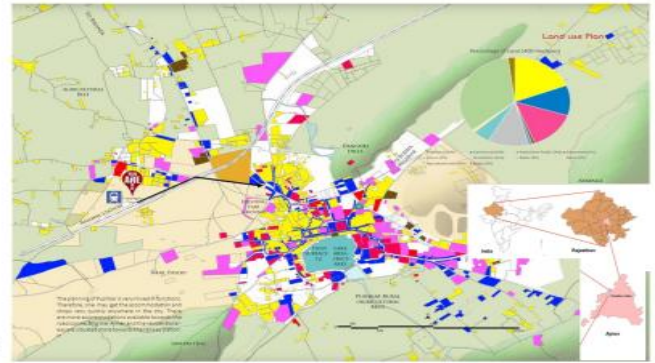
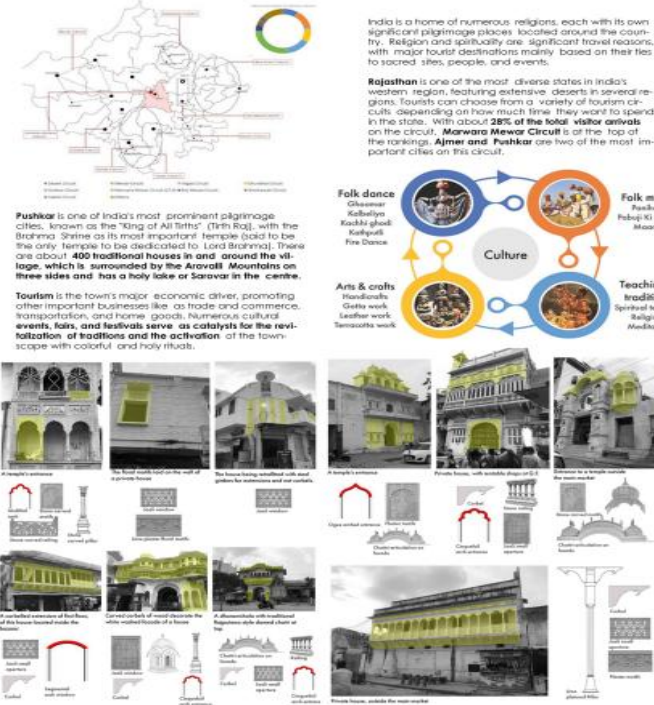

Architectural study



Vertically projecting profiles
In order to cut down the harsh glare of the sun, the external facade of the building is treated with projecting profiles of elements that are specially designed. These profiles are common to the whole region of Rajasthan. Most commonly, **Shankha** or conch-shaped elements with a semi-circular cornice and **gull stone** elements are used. The **gull stone** cornice is placed along the facade of the building or on top of the openings to reduce the heat and glare of the sun. All these elements are put together to not only protect the building from the sun, but also give it a traditional and ornate look.

Courtyard-centric organization
The basic principle of spatial organization in this region is structuring around an open space or **haveli** courtyard which is the private open space for the house.

Orientation
Mostly all buildings are oriented along the axis of the town, oriented in the North-east South-west direction. This also helps in the flow of wind, not only in the streets but in the house itself.

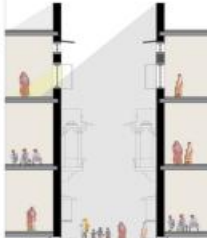

Compact planning and thermal massing
The high density of the urban fabric is due to the compact planning of the town. The built-up area is arranged around open spaces forming a continuous mass. The **edge-to-edge** sharing of wall and buffer space like semi-open verandahs on the lower and upper floors make the inner space to remain cool.

The **thick stone walls** that enclose the building create a thermal mass which delays the penetration of heat into the building during daytime and cools it during the night. The roof is almost as thick as the walls to insulate the inside from the heat.

Materials and construction system

Due to the high availability of stone in the region, earlier structures have used stone as a preferred building material. Stone is readily available from the nearby stone quarries. The **predominance of stone** is seen at all levels from the structure and openings to intricate carving and perforations in all elements. The use of **timber** is also common for openings and other elements like columns, brackets, etc. Nowadays, brick and concrete have become a common material in the area too. The **combination of brick and stone** is used to make walls of the new construction taking place in Pushkar.

The structural system of individual buildings is commonly **load-bearing** due to the compressive strength of stone. The typical local construction system uses random rubble up to the plinth level. The walls are approximately **600mm thick**. Openings in the walls are mostly arched and the semi-open spaces are made by a series of columns instead of an opaque wall. The **slab is made of stone**. Flat terraces are most common in Pushkar. For insulation, **inverted clay pots** are used in the slab to create a cavity and thereby reduce the penetration of heat inside the building.



Repetition of openings

It is a region where there is a need for ventilation as well as keeping out the sun, the facades are designed to tackle both situations. In the inner streets of the town, openings on the ground floor are limited in number and are above eye level to maintain privacy. As one moves upwards, the number and therefore, the porosity of the openings increase. Mostly, it is observed that the primary and secondary streets in Pushkar comprise of semi-open shops on the lower floor and the above residential area has repeated windows or **parikhwas** with or without jalis according to the orientation of the building and the need. All windows have **chajjas** above them to protect the inside from the heat.



DEMOGRAPHICS

| Year | Population | Male | Female | Sex Ratio | Urban | Rural | Total |
|------|------------|--------|--------|-----------|--------|--------|--------|
| 1991 | 10,000 | 5,000 | 5,000 | 1000 | 5,000 | 5,000 | 10,000 |
| 2001 | 15,000 | 7,500 | 7,500 | 1000 | 7,500 | 7,500 | 15,000 |
| 2011 | 20,000 | 10,000 | 10,000 | 1000 | 10,000 | 10,000 | 20,000 |

Occupational structure of Pushkar Master Plan 2011-2031

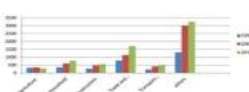

Graph showing change in occupational structure in year 1991, 2001, 2011.

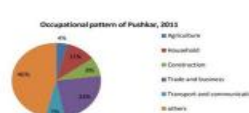

Occupational pattern of Pushkar, 2011

Land use 2011: existing

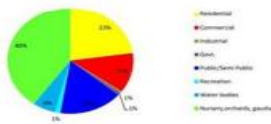

Land use 2031: proposed

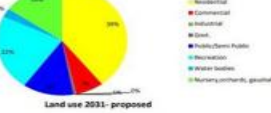

Occupational pattern: Tourism is the town's major economic driver, promoting other important businesses like trade and commerce, transportation, and home goods. People are involved in religious commercial activities, which are their traditional employment. In the bulk of the temples in Pushkar which number approximately 500. Many young people, however, have started their own enterprises as a result of the surge in foreign tourists. Trade and commerce are connected to temple requirements and some pilgrims and tourists. In town, there are no wholesale activities.

OBJECTIVE

To expose and study the culture of the region and tourism for developing the **integrated tourism** aspects through built and open environments.
To promote local performing arts and crafts by providing a platform for **cultural events throughout the year** thereby, spacing their contribution in the economy within the region.
To educate the visitors about the town, by providing different modes of interpretation and idea conveyance.
To improve local employment opportunities, through training of new generation of artists, by providing **workshop facilities**.



Design Brief

Religious or pilgrimage tourism exists since ages and has been one of the most popular form of tourism. It is driven by numerous factors such as **pilgrimage, healing, historic significance, cultural value, architecture, beauty of the natural surroundings, expressing love and reverence for God, and profound soul searching**. Together these characteristics give birth to an environment of curiosity and interest.

Pilgrimage tourism holds a dominant stake in the development of various regions. It provides a **distinct identity and character to the whole region**. Efficient development of resources which promote and facilitate it, needs to be conceived and implemented for the **economic and social benefits of the numerous dependent on it**.

India is a land of many regions and pilgrim tourism has always been quite popular. The vast potential of tourism in this sector is now put up to consideration with varied govt. schemes in place to tap on it and encourage community-based development in such places.

Pushkar in Rajasthan, is a part of the ambitious development plans of pilgrimage sites in India, being one of the most prominent pilgrimage cities, known as the **'King of all fairs'** (Fairs) with the **Shri Krishna** as its most important temple. Pushkar is the only temple to be dedicated to Lord Krishna. Numerous cultural events, fairs, and festivals are celebrated for the revival of traditions and the celebration of the town's rich heritage with colorful and musical. The town holds the second largest fair in India the **Pushkar Fair** which is an **amalgamation of ethnic, cultural themes, thousands of cattle and almost a million visitors**.

The main aim of this design is to propose a **cultural tourism center**, which will help to establish a strong relationship between the visitor and the town, that will help to enhance the experience of the visitor and help local artisans and craftsmen with greater opportunities.

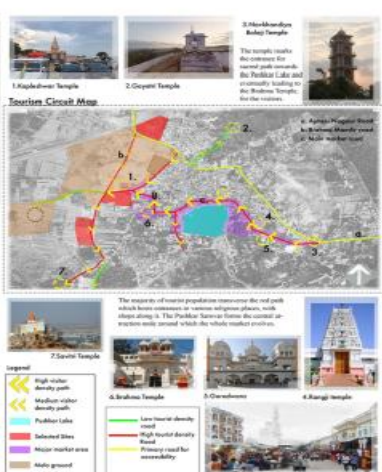
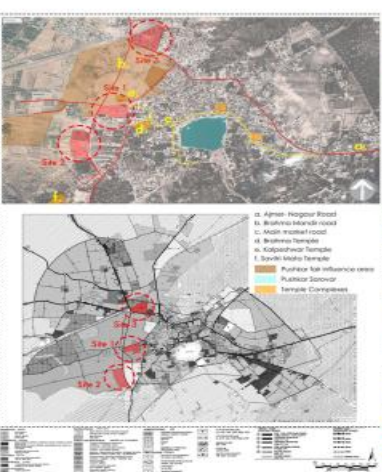

CUT, FOLD & SKEW – PAPER ART (ORIGAMI)

Mentor : Ar. Sujit Vasant Jadhav
(Landscape Architect & Artist)

ORIGAMI FOLD RELEVANCE TO ARCHITECTURAL FORM -
The Folded Motif Here Serves As An Airport facade With
Beautiful Landscape Around It.

NIDHI CHATURVEDI
SITE DEVELOPMENT WITH FOLDED MOTIF

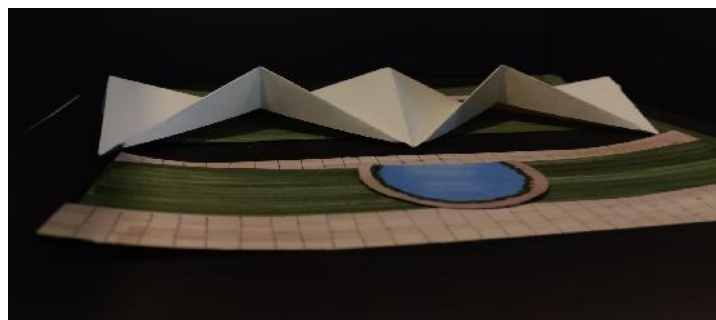

ORIGAMI FOLD RELEVANCE TO ARCHITECTURAL FORM DESCRIPTION : This Fold Is Assumed To Be Cafeteria Where Fold Is
Working As An Roof In It For Better Effect.

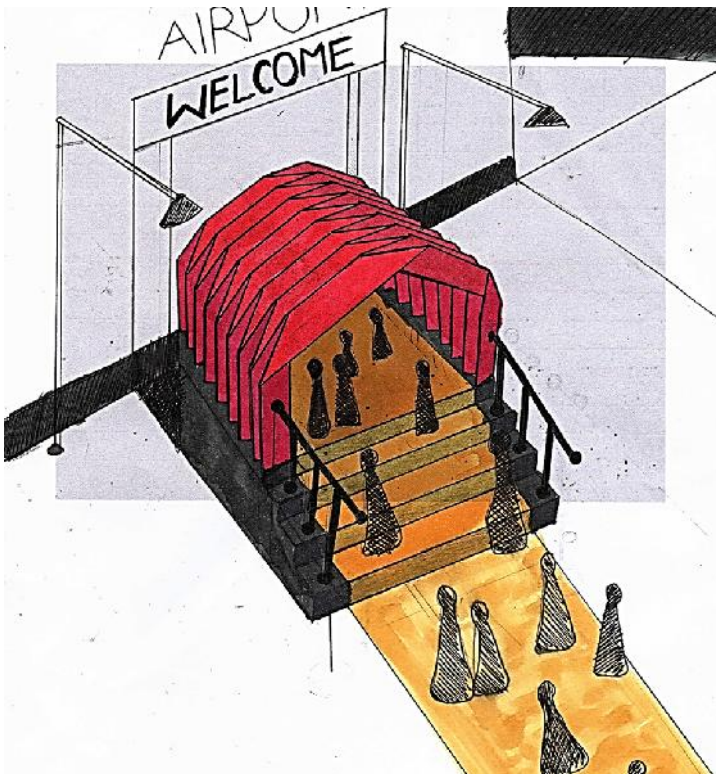
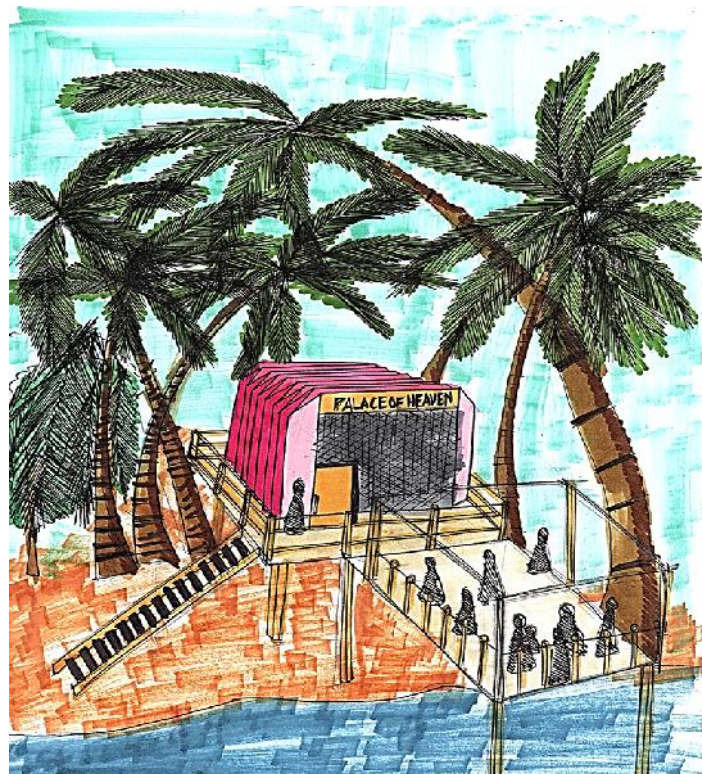

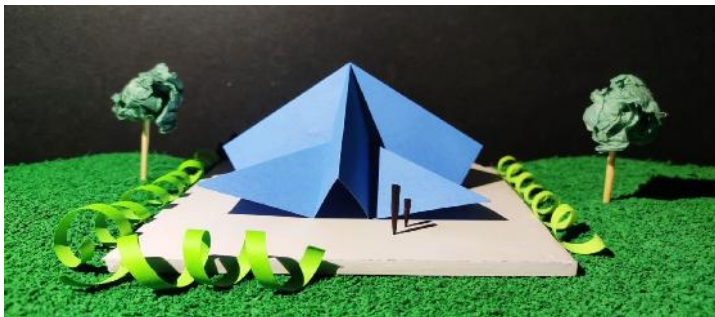
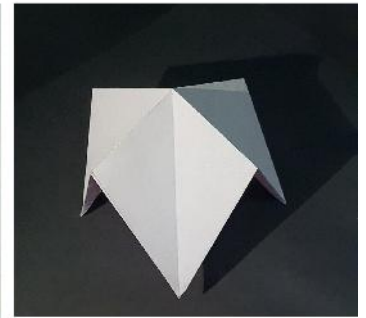
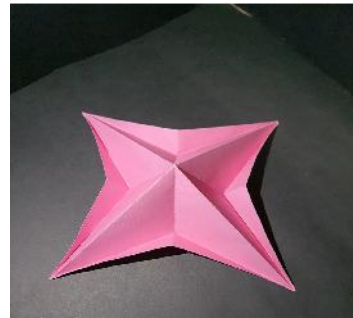
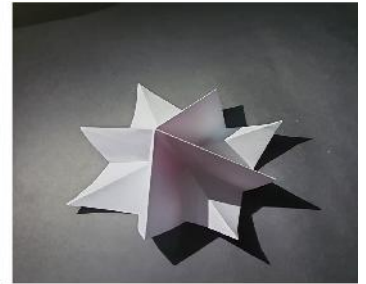
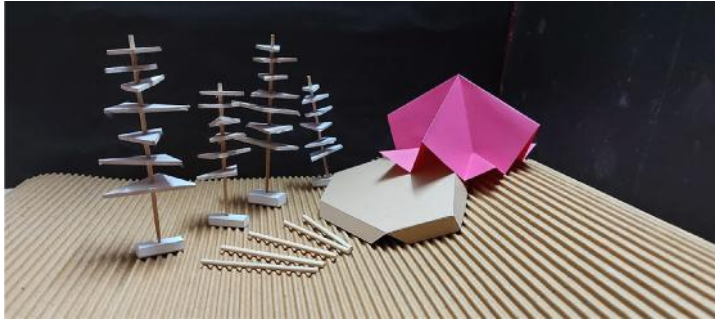

ORIGAMI FOLD RELEVANCE TO ARCHITECTURAL FORM DESCRIPTION -

A structure in the snow with forest in surrounding. Entry ways with wooden fences and beautiful triangular entry ways and aesthetic façade.





Zagdu Singh Charitable Trust's (Regd.)

THAKUR SCHOOL OF ARCHITECTURE & PLANNING

(Approved by COA, AICTE, DTE, Govt. of Maharashtra & Affiliated to University of Mumbai)

• Recognized under Section 2f of UGC Act, 1956 • ISO 9001 : 2015 Certified

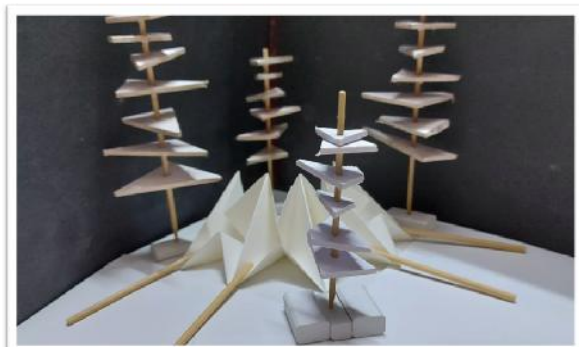

SANIKA WARANG

STUDENTS' TESTIMONIALS



It is my immense luck and fortune to be a part of Thakur School of Architecture and Planning I. The entire faculty and department leaves no stone unturned to shape one's future. It's been a wonderful experience of learning with prolific exposure to outside. Huge respect, love and devotion for entire faculty members and seniors. It's their efforts that make me to count myself into better professionals.

Sanskriti Sawant
2nd Year (B.Arch.)



Since I have join TSAP its been an another experience be it online or offline. Offline is much better than online you get to learn more and the faculty can keep a better watch at you also, our faculty has helped me learn and a lot. But the most I have learnt is by my seniors during these few months of offline, and because of NASA I have developed lots of new skill and are still developing due the help of my dear seniors.

Allen George
2nd Year (B.Arch.)